

Addenda

PC Non-Refrigerated Pastry Case

Structural Concepts®

- **PC3982** 41"L x 39"D x 83-1/4"H
- **PC5682** 58"L x 39"D x 83-1/4"H
- **PC7482** 76"L x 39"D x 83-1/4"H

Included

- 12" Straight blade power cord
- Angled mirror in upper display
- Clear glass swinging doors (self-closing)
- LED 3500K top & shelf lights
- Levelers
- One year parts & labor warranty
- PC3982 holds (10) 18" x 26" trays
- PC5682 holds (15) 18" x 26" trays
- PC7482 holds (20) 18" x 26" trays
- Shelving removable and adjustable on 1" centers



Specify	Standard Features	Additional Options
EXTERIOR COLOR	• Laminated (non-premium) Confirm pattern/grain direction	• Laminated (premium) Confirm pattern/grain direction • Painted (stock colors, specify RAL#)
INTERIOR COLOR	• Black	• White
BASE	• Straight base w/o front storage	• Angled base w/ front storage & waste bin • Straight base w/ front storage & waste bin
END PANEL LEFT	• Full end panel w/mirror interior	• Cutaway w/glass end panel • None (specify per line-up)
END PANEL RIGHT	• Full end panel w/mirror interior	• Cutaway w/glass end panel • None (specify per line-up)
HEADER	¹ • Flat	¹ • Curved
LOWER REAR	• Open	• Dry storage w/ sliding solid doors
UPPER REAR	• Solid back panel	• Reflective glass rear sliding doors
SHELVING	• Tray support lighted shelves, (trays not included)	• Wire rack shelves, lighted
MISCELLANEOUS		• Header exhaust fans • Seal between doors • Second year parts & labor warranty
ACCESSORIES		• Price tag molding (matches interior color)

Std Notes: 1 - Laminated Only

Option Notes: 1 - Painted Only

Addenda

PC Non-Refrigerated Pastry Case

Structural Concepts®

Intended Environment: Type I - Designed to operate in ambient conditions of 75°F with 55% relative humidity unless noted otherwise in system information below.

Zone	Intended Product To Be Displayed	Warmest Avg Prod Temp ° F
1	Unpackaged non-refrigerated products	Ambient

PLAN VIEW

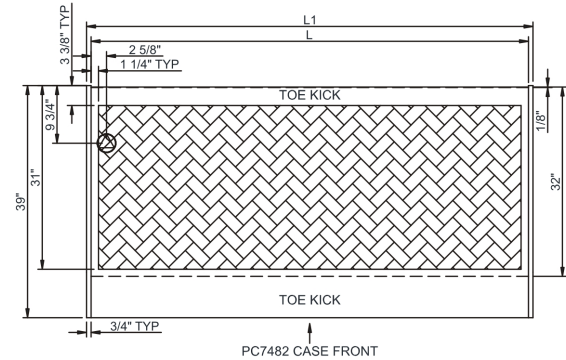

SIDE VIEW

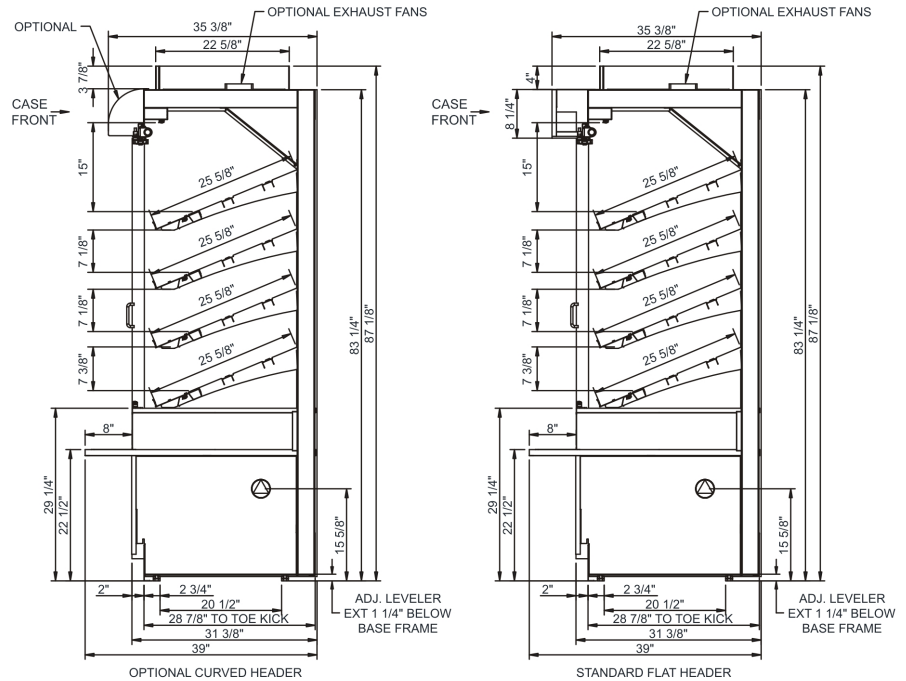

NOTE: ALL DIMENSIONS APPROXIMATE

ELECTRICAL JUNCTION BOX
(SUPPLIED WITH 6" LEADS OR POWER CORD).
 LOCATION OF DRAIN TUBE FOR REMOTE REF.
ONLY (SUPPLIED WITH 3/4" OR 1 1/2" PVC TUBE).

REFRIGERATION LINE CONNECTION.
 REMOTE FLOOR SINK & UTILITIES
ACCESS AREA.

SELF-CONTAINED CASE SERVICE ACCESS AREA.
 DRY CASE SERVICE ACCESS AREA.

Model Technical Specifications

Model Technical Specifications																
Model	L"	L1"	L2"	System Circuit Volts			Phs	Freq	Amps ***	Watts	Wires	NEMA Plug	SST	Conv. Rack BTU/H	Para. Rack BTU/H	Est Wt
PC3982	39.00	41.00	.00	Ambient/Lights (N/A)	Circuit #1	110-120	1	60	1.06	117	2+G	5-15P	N/A	N/A	N/A	700
				Ambient/Lights (N/A)	Circuit #1	208-240	1	50	0.47	242	2+G	Leads Single	N/A	N/A	N/A	
PC5682	56.00	58.00	.00	Ambient/Lights (N/A)	Circuit #1	110-120	1	60	1.52	160	2+G	5-15P	N/A	N/A	N/A	1,050
PC7482	74.00	76.00	.00	Ambient/Lights (N/A)	Circuit #1	110-120	1	60	1.77	200	2+G	5-15P	N/A	N/A	N/A	1,250

*** Does not include electric defrost on freezer models.

Regulatory Approvals:

All Models ETL Listed to UL 65
ETL Sanitation to NSF/ANSI 2



DOE 2017
Energy Efficiency
Compliant

Important Notes:

- 1) ELECTRICAL NOTE: If GFCI is required, a GFCI breaker MUST be used in lieu of a GFCI receptacle.
- 2) 40" minimum door entry clearance required (without shipping skid).
- 3) Units are supplied with levelers which must be adjusted during installation to ensure the unit is level and plumb.
- 4) Dimensions reflect levelers extended 1-1/4".

⚠ WARNING: This product can expose you to chemicals, including Urethane (Ethyl Carbamate), which are known to the State of California to cause cancer and birth defects or other reproductive harm. For more information go to www.P65Warnings.ca.gov.

Note: Information is subject to change at any time. Visit www.structuralconcepts.com for the most current specs.

21865406

Revised 1-12-2022